

# Spur Gears

## European Standard Series

### SPUR GEARS

Z	Mod.1				Mod.1.5				Mod.2				Mod.2.5			
	d <sub>e</sub>	d <sub>p</sub>	d <sub>m</sub>	D1	d <sub>e</sub>	d <sub>p</sub>	d <sub>m</sub>	D1	d <sub>e</sub>	d <sub>p</sub>	d <sub>m</sub>	D1	d <sub>e</sub>	d <sub>p</sub>	d <sub>m</sub>	D1
12	14	12	9	-	21.0	18.0	14	8	28	24	18	10	35.0	30.0	22	10
13	15	13	10	-	22.5	19.5	15	8	30	26	20	10	37.5	32.5	25	10
14	16	14	11	-	24.0	21.0	17	8	32	28	22	10	40.0	35.0	28	10
15	17	15	12	-	25.5	22.5	18	8	34	30	24	10	42.5	37.5	30	10
16	18	16	13	-	27.0	24.0	19	8	36	32	25	10	45.0	40.0	32	12
17	19	17	14	-	28.5	25.5	20	8	38	34	25	10	47.5	42.5	35	12
18	20	18	15	8	30.0	27.0	20	8	40	36	25	10	50.0	45.0	35	12
19	21	19	15	8	31.5	28.5	20	8	42	38	25	10	52.5	47.5	35	12
20	22	20	16	8	33.0	30.0	25	8	44	40	30	10	55.0	50.0	40	12
21	23	21	16	8	34.5	31.5	25	10	46	42	30	12	57.5	52.5	40	14
22	24	22	16	8	36.0	33.0	25	10	48	44	30	12	60.0	55.0	45	14
23	25	23	18	8	37.5	34.5	25	10	50	46	30	12	62.5	57.5	45	14
24	26	24	20	10	39.0	36.0	25	10	52	48	35	12	65.0	60.0	45	14
25	27	25	20	10	40.5	37.5	25	10	54	50	35	12	67.5	62.5	50	14
26	28	26	20	10	42.0	39.0	30	12	56	52	40	12	70.5	65.0	50	14
27	29	27	20	10	43.5	40.5	30	12	58	54	40	12	72.5	67.5	50	14
28	30	28	20	10	45.0	42.0	30	12	60	56	40	12	75.0	70.0	50	14
29	31	29	20	10	46.5	43.5	30	12	62	58	40	14	77.5	72.5	50	14
30	32	30	20	10	48.0	45.0	30	12	64	60	40	14	80.0	75.0	55	14
31	33	31	25	10	49.5	46.5	35	12	66	62	45	14	82.5	77.5	55	16
32	34	32	25	10	51.0	48.0	35	12	68	64	45	14	85.0	80.0	55	16
33	35	33	25	10	52.5	49.5	35	12	70	66	45	14	87.5	82.5	55	16
34	36	34	25	10	54.0	51.0	35	12	72	68	45	14	90.0	85.0	55	16
35	37	35	25	10	55.5	52.5	35	12	74	70	45	14	92.5	87.5	60	16
36	38	36	25	10	57.0	54.0	35	12	76	72	45	14	95.0	90.0	60	16
37	39	37	25	10	58.5	55.5	40	12	78	74	50	14	97.5	92.5	60	16
38	40	38	25	10	60.0	57.0	40	12	80	76	50	14	100.0	95.0	60	16
39	41	39	25	10	61.5	58.5	40	12	82	78	50	14	102.5	97.5	60	16
40	42	40	25	10	63.0	60.0	40	12	84	80	50	14	105.0	100.0	70	16
41	43	41	30	10	64.5	61.5	40	12	86	82	55	16	107.5	102.5	70	16
42	44	42	30	10	66.0	63.0	50	12	88	84	55	16	110.0	105.0	70	16
43	45	43	30	10	67.5	64.5	50	12	90	86	55	16	112.5	107.5	70	16
44	46	44	30	10	69.0	66.0	50	12	92	88	60	16	115.0	110.0	70	16
45	47	45	30	12	70.5	67.5	50	12	94	90	60	16	117.5	112.5	70	16
46	48	46	30	12	72.0	69.0	50	14	96	92	60	16	120.0	115.0	70	16
47	49	47	30	12	73.5	70.5	50	14	98	94	70	16	122.5	117.5	80	20
48	50	48	30	12	75.0	72.0	50	14	100	96	70	16	125.0	120.0	80	20
49	51	49	30	12	76.5	73.5	50	14	102	98	70	16	127.5	122.5	80	20
50	52	50	30	12	78.0	75.0	50	14	104	100	70	16	130.0	125.0	80	20
51	53	51	40	12	79.5	76.5	60	14	106	102	70	16	132.5	127.5	80	20
52	54	52	40	12	81.0	78.0	60	14	108	104	70	16	135.0	130.0	90	20
53	55	53	40	12	82.5	79.5	60	14	110	106	70	16	137.5	132.5	90	20
54	56	54	40	12	84.0	81.0	60	14	112	108	70	16	140.0	135.0	90	20
55	57	55	40	12	85.5	82.5	60	14	114	110	70	16	142.5	137.5	90	20
56	58	56	40	12	87.0	84.0	60	16	116	112	70	16	145.0	140.0	100	20
57	59	57	40	12	88.5	85.5	60	16	118	114	70	16	147.5	142.5	100	20
58	60	58	40	12	90.0	87.0	60	16	120	116	70	16	150.0	145.0	100	20
59	61	59	40	12	91.5	88.5	60	16	122	118	70	16	152.5	147.5	100	20
60	62	60	40	12	93.0	90.0	60	16	124	120	70	16	155.0	150.0	100	20
61	63	61	50	12	94.5	91.5	70	16	126	122	80	16				
62	64	62	50	12	96.0	93.0	70	16	128	124	80	16				
63	65	63	50	12	97.5	94.5	70	16	130	126	80	16				
64	66	64	50	12	99.0	96.0	70	16	132	128	80	16				
65	67	65	50	12	100.5	97.5	70	16	134	130	80	16	167.5	162.5		20
66	68	66	50	12	102.0	99.0	70	16	136	132	80	16				
67	69	67	50	12	103.5	100.5	70	16	138	134	80	16				
68	70	68	50	12	105.0	102.0	70	16	140	136	80	16				
69	71	69	50	12	106.5	103.5	70	16	142	138	80	16				
70	72	70	50	12	108.0	105.0	70	16	144	140	80	16	180.0	175.0		20
72	74	71		12	111.0	108.0		16	148	144		16	185.0	180.0		20
75	77	75		12	115.0	112.5		16	154	150		20	192.5	187.5		20
76	78	76		12	117.0	114.0		16	156	152		20	195.0	190.0		20
80	82	80		12	123.0	120.0		16	164	160		20	205.0	200.0		25
85	87	85		12	130.0	127.5		16	174	170		20	217.5	212.5		25
90	92	90		12	138.0	135.0		16	184	180		20	230.0	225.0		25
95	97	95		12	145.5	142.5		16	194	190		20	242.5	237.5		25
100	102	100		12	153.0	150.0		16	204	200		20	255.0	250.0		25
110	112	110		12	168.0	165.0		16	224	220		20	280.0	275.0		25
114	116	114		12	174.0	171.0		16	232	228		20	290.0	285.0		25
120	122	120		12	183.0	180.0		16	244	240		20	305.0	300.0		25
127	129	127		12	193.5	190.5		16	258	254		20	322.5	317.5		25

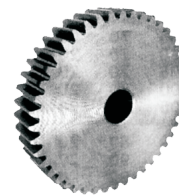
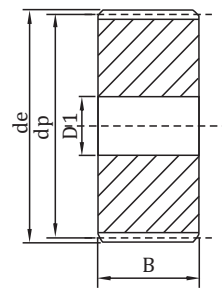
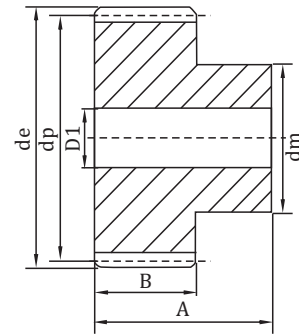

#### Tooth width "B"

- Module 1 =15mm
- Module 1.5 =17mm
- Module 2 =20mm
- Module 2.5 =25mm
- Module 3 =30mm
- Module 4 =40mm
- Module 5 =50mm
- Module 6 =60mm

#### Tooth width "A"

- Module 1 =25mm
- Module 1.5 =30mm
- Module 2 =35mm
- Module 2.5 =45mm
- Module 3 =50mm
- Module 4 =60mm
- Module 5 =75mm
- Module 6 =80mm

Material C45

Pressure angle 20°