

Steel Stock Sprockets American Standard Series

No.60

◇ Pitch 3/4" ◇ Roller Φ 0.468" ◇ Tooth width B1 0.459"

Single-Type A

Single-Type B

No. Teeth	De	Type	Number	D1	Weight Lbs. (Approx.)	Number	Type	D1		Dm	A	Weight Lbs. (Approx.)
								Min	Max.			
8	2.260					60B08	B	5/8	5/8	1 ^{5/32} *	1 1/4	.54
9	2.510					60B09	B	3/4	7/8	1 ^{7/16} *	1 1/4	.64
10	2.760	A	60A10	3/4	.44	60B10	B	3/4	1 1/8	1 ^{7/16} *	1 1/4	.99
11	3.000	A	60A11	3/4	.54	60B11	B	3/4	1 5/16	2 ^{7/16} *	1 1/4	1.16
12	3.250	A	60A12	3/4	.68	60B12	B	3/4	1 7/8	2 ^{7/8} *	1 1/4	1.47
13	3.490	A	60A13	3/4	.80	60B13	B	3/4	1 1/2	2 ^{15/32}	1 1/4	1.66
14	3.740	A	60A14	3/4	.94	60B14	B	3/4	1 3/4	2 ^{7/16}	1 1/4	2.00
15	3.980	A	60A15	3/4	1.08	60B15	B	3/4	1 7/8	2 ^{7/8}	1 1/4	2.51
16	4.220	A	60A16	3/4	1.24	60B16	B	3/4	2	3 ^{7/16}	1 1/4	2.81
17	4.460	A	60A17	3/4	1.44	60B17	B	3/4	2 1/4	3 3/4	1 1/4	3.22
18	4.700	A	60A18	3/4	1.62	60B18	B	3/4	2 5/8	3 1/2	1 1/4	3.72
19	4.950	A	60A19	3/4	1.84	60B19	B	3/4	2 3/8	3 1/2	1 1/4	3.92
20	5.190	A	60A20	3/4	2.12	60B20	B	3/4	2 5/8	3 7/8	1 1/4	4.63
21	5.430	A	60A21	3/4	2.28	60B21	B	3/4	2 3/4	4	1 1/4	5.00
22	5.670	A	60A22	3/4	2.48	60B22	B	3/4	2 3/4	4	1 1/4	5.25
23	5.910	A	60A23	3/4	2.68	60B23	B	3/4	2 3/4	4	1 1/4	5.48
24	6.150	A	60A24	23/32	3.00	60B24	B	3/4	2 3/4	4	1 1/4	5.78
25	6.390	A	60A25	23/32	3.34	60B25	B	3/4	2 3/4	4	1 1/4	6.13
26	6.630	A	60A26	23/32	3.54	60B26	B	3/4	2 3/4	4	1 1/4	6.38
27	6.870	A	60A27	23/32	3.96	60B27	B	3/4	2 3/4	4	1 1/4	6.72
28	7.110	A	60A28	23/32	4.14	60B28	B	3/4	2 3/4	4	1 1/4	6.88
29	7.350	A	60A29	23/32	4.40	60B29	B	3/4	2 3/4	4	1 1/4	7.28
30	7.590	A	60A30	23/32	4.78	60B30	B	3/4	2 3/4	4	1 1/4	7.58
31	7.830	A	60A31	23/32	5.24	60B31	B	3/4	2 3/4	4	1 1/4	7.72
32	8.070	A	60A32	23/32	5.52	60B32	B	3/4	2 3/4	4	1 1/4	8.26
33	8.300	A	60A33	15/16	5.86	60B33	B	1	2 3/4	4	1 1/4	8.42
34	8.540	A	60A34	15/16	6.16	60B34	B	1	2 3/4	4	1 1/4	8.80
35	8.780	A	60A35	15/16	6.78	60B35	B	1	2 3/4	4	1 1/4	9.04
36	9.020	A	60A36	15/16	6.82	60B36	B	1	2 3/4	4	1 1/4	9.60
37	9.260	A	60A37	15/16	7.52	60B37	B	1	2 3/4	4	1 1/4	10.24
38	9.500	A	60A38	15/16	7.84	60B38	B	1	2 3/4	4 1/4	1 1/4	10.84
39	9.740	A	60A39	15/16	8.28	60B39	B	1	2 3/4	4 1/4	1 1/4	11.36
40	9.980	A	60A40	15/16	8.56	60B40	B	1	2 3/4	4 1/4	1 1/4	11.50
41	10.220	A	60A41	15/16	9.10	60B41	B	1	2 3/4	4 1/4	1 1/4	12.14
42	10.460	A	60A42	15/16	9.74	60B42	B	1	2 3/4	4 1/4	1 1/4	12.74
43	10.700	A	60A43	15/16	9.84	60B43	B	1	2 3/4	4 1/4	1 1/4	13.00
44	10.940	A	60A44	15/16	10.76	60B44	B	1 ^{5/16}	2 3/4	4 1/4	1 1/4	13.88
45	11.180	A	60A45	15/16	11.08	60B45	B	1 ^{5/16}	2 3/4	4 1/4	1 1/4	13.98
46	11.420	A	60A46	15/16	11.50	60B46	B	1 ^{5/16}	2 3/4	4 1/4	1 1/4	14.60
47	11.650	A	60A47	15/16	12.32	60B47	B	1 ^{5/16}	2 3/4	4 1/4	1 1/4	15.00
48	11.890	A	60A48	15/16	12.42	60B48	B	1 ^{5/16}	2 3/4	4 1/4	1 1/4	15.82
49	12.130	A	60A49	15/16	12.92	60B49	B	1 ^{5/16}	2 3/4	4 1/4	1 1/4	15.90
50	12.370	A	60A50	15/16	13.98	60B50	B	1 ^{5/16}	2 3/4	4 1/4	1 1/4	16.98
51	12.610	A	60A51	15/16	14.58	60B51	B	1 ^{5/16}	2 3/4	4 1/4	1 1/4	17.66
52	12.850	A	60A52	15/16	14.60	60B52	B	1 ^{5/16}	2 3/4	4 1/4	1 1/4	17.93
53	13.090	A	60A53	15/16	15.84	60B53	B	1 ^{5/16}	2 3/4	4 1/4	1 1/4	17.99
54	13.330	A	60A54	15/16	15.92	60B54	B	1 ^{5/16}	2 3/4	4 1/4	1 3/4	21.14
55	13.570	A	60A55	1 1/4	16.96	60B55	B	1 1/4	2 3/4	4 1/4	1 3/4	21.60
56	13.810	A	60A56	1 1/4	17.60	60B56	B	1 1/4	2 3/4	4 1/4	1 3/4	21.88
57	14.040	A	60A57	1 1/4	17.62	60B57	B	1 1/4	2 3/4	4 1/4	1 3/4	22.26
58	14.280	A	60A58	1 1/4	19.00	60B58	B	1 1/4	2 3/4	4 1/4	1 3/4	22.80
59	14.520	A	60A59	1 1/4	19.20	60B59	B	1 1/4	2 3/4	4 1/4	1 3/4	23.86
60	14.760	A	60A60	1 1/4	20.02	60B60	B	1 1/4	2 3/4	4 1/4	1 3/4	25.22
64	15.720	A	60A64	1 1/4	23.00	60B64	B	1 1/4	2 3/4	4 1/4	1 3/4	27.40
65	15.960	A	60A65	1 1/4	23.24	60B65	B	1 1/4	2 3/4	4 1/4	1 3/4	28.92
66			60A66	1 1/4	24.42							
68	16.670	A	60A68	1 1/4	25.54	60B68	B	1 1/4	2 3/4	4 1/4	1 3/4	30.38
70	17.150	A	60A70	1 1/4	27.20	60B70	B	1 1/4	2 3/4	4 1/4	1 3/4	31.98
72	17.630	A	60A72	1 1/4	28.90	60B72	B	1 1/4	2 3/4	4 1/4	2	34.18
76	18.580	A	60A76	1 1/4	32.34	60B76	B	1 1/4	2 3/4	4 1/4	2	38.06
80	19.540	A	60A80	1 1/4	45.50	60B80	B	1 1/4	2 3/4	4 1/4	2	41.88
84	20.490	A	60A84	1 1/4	40.18	60B84	B	1 1/4	3 1/4	4 3/4	2	46.46
90	21.930	A	60A90	1 1/4	43.44	60B90	B	1 1/4	3 ^{5/16}	5	2 1/4	63.20
96	23.360	A	60A96	1 1/4	52.02	60B96	B	1 1/4	3 3/4	5 1/2	2 1/4	63.08
112	27.180	A	60A112	1 1/4	70.80	60B112	B	1 1/4	3 3/4	5 1/2	2 1/4	81.78

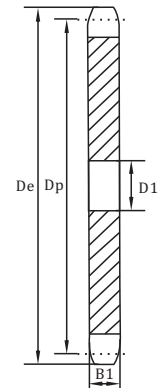

TYPE A

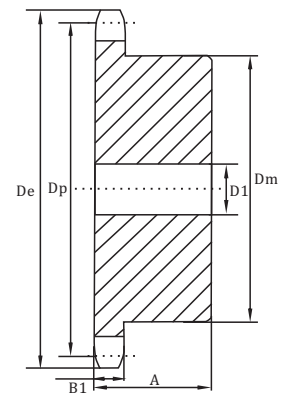
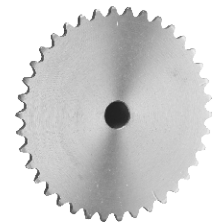

TYPE B



★ Has recessed groove in hub for chain clearance.

Maximum bores shown will accommodate standard keyseat and setscrew over keyseat.

Slightly larger bores are possible with no keyseat, shallow keyseat, or setscrew at angle to keyseat.

Steel Stock Sprockets American Standard Series

No.60-2

◇ Pitch 3/4" ◇ Roller Φ 0.468" ◇ Tooth width b1 0.444" ◇ Tooth width B2 1.341"

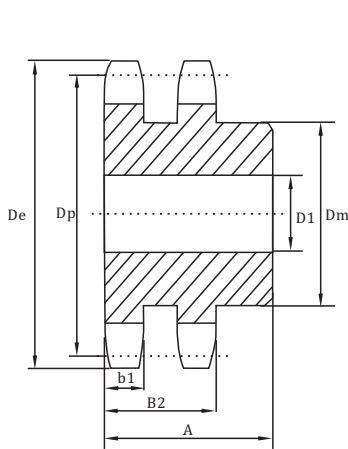

TYPE B

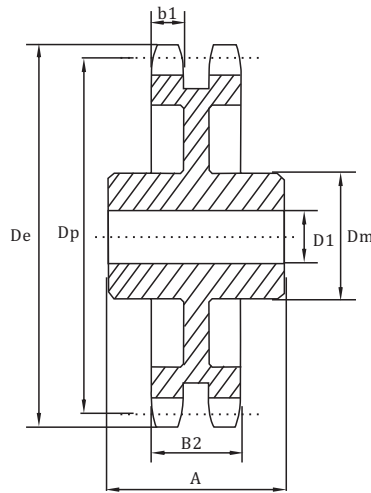

TYPE C



Double-Type B & C

No. Teeth	Number	De	Type	D1		Dm	A	Weight Lbs. (Approx.)
				Min	Max.			
11	D60B11H	3.000	B	1	1 1/4	1 7/16	2 7/8	1.62
12	D60B12H	3.250	B	1	1 7/16	2 7/8	2 7/8	2.20
13	D60B13H	3.490	B	1	1 1/2	2 7/8	2 7/8	2.60
14	D60B14H	3.740	B	1	1 3/4	2 7/8	2 7/8	3.24
15	D60B15H	3.980	B	1	1 7/8	2 7/8	2 7/8	3.96
16	D60B16H	4.220	B	1	2	3	2 7/8	4.62
17	D60B17H	4.460	B	1	2 1/4	3 1/4	2 7/8	5.40
18	D60B18H	4.700	B	1	2 3/8	3 1/2	2 7/8	6.24
19	D60B19H	4.950	B	1	2 1/2	3 17/16	2 7/8	7.00
20	D60B20H	5.190	B	1	2 1/2	3 3/4	2 7/8	7.72
21	D60B21H	5.430	B	1	2 3/4	4 1/8	2 7/8	8.82
22	D60B22H	5.670	B	1	2 3/4	4 1/4	2 7/8	9.68
23	D60B23H	5.910	B	1	2 3/4	4 1/4	2 7/8	10.30
24	D60B24H	6.150	B	1	2 3/4	4 1/4	2 7/8	11.14
25	D60B25H	6.390	B	1	2 3/4	4 1/4	2 7/8	11.96
26	D60B26	6.630	B	1	2 3/4	4 1/4	2 7/8	12.70
30	D60B30	7.590	B	1	2 3/4	4 1/4	2 7/8	16.36
32	D60B32	8.070	B	1 1/4	3	4 1/2	2 7/8	19.52
35	D60B35	8.780	B	1 1/4	3	4 1/2	2 7/8	22.80
36	D60B36	9.020	B	1 1/4	3	4 1/2	2 7/8	23.82
40	D60B40	9.980	B	1 1/4	3 1/4	4 3/4	2 3/4	30.84
42	D60B42	10.460	B	1 1/4	3 1/4	4 3/4	2 3/4	33.08
45	D60B45	11.180	B	1 1/4	3 1/4	4 3/4	2 3/4	37.08
52	D60B52	12.850	B	1 1/4	3 1/4	4 3/4	2 3/4	48.70
60	D60B60	14.760	B	1 1/4	3 1/4	4 3/4	2 3/4	63.10
68	D60C68	16.670	C	1 1/4	3 7/16	5	3	53.68
72	D60C72	17.630	C	1 1/4	3 7/16	5	3	53.74
76	D60C76	18.580	C	1 1/4	3 7/16	5	3	60.28
95	D60C95	23.120	C	1 1/4	3 3/4	5 1/2	3 1/2	87.14

NOTE: Double 60 stock sprockets with 25 teeth or less have Hardened teeth.

Maximum bores shown will accommodate standard keyseat and setscrew over keyseat.

Slightly larger bores are possible with no keyseat, shallow keyseat, or setscrew at angle to keyseat.

Steel Stock Sprockets American Standard Series

No.60-3

◇ Pitch $3/4"$ ◇ Roller Φ $0.468"$
 ◇ Tooth width $b1$ $0.444"$ ◇ Tooth width $B2$ $1.341"$ ◇ Tooth width $B3$ $2.238"$

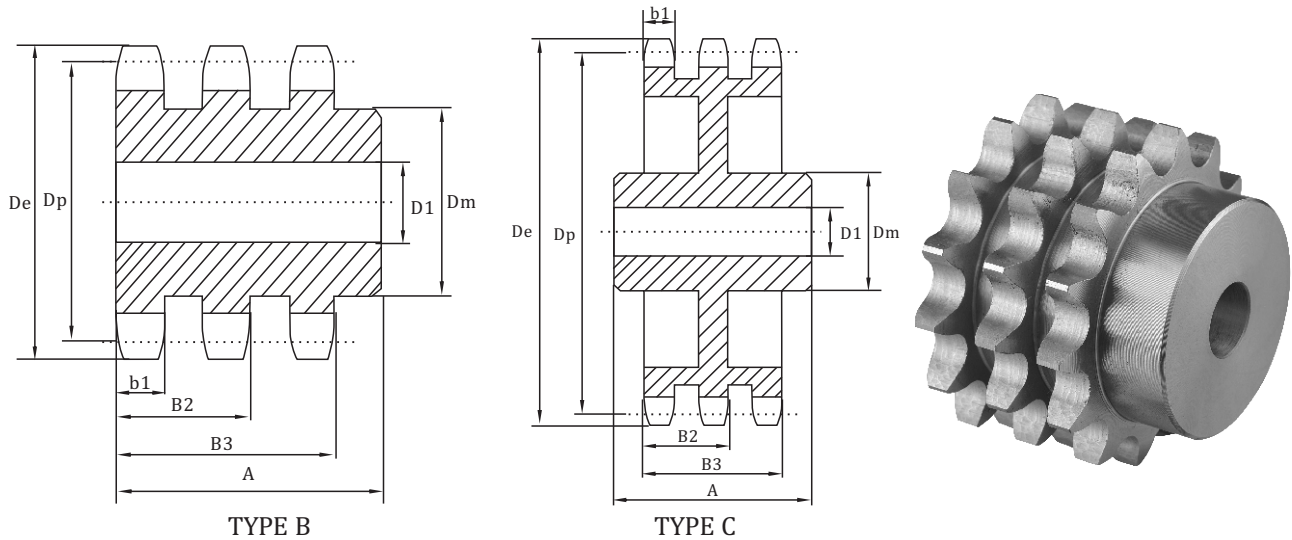

Triple-Type B & C

No. Teeth	Number	De	Type	D1		Dm	A	Weight Lbs. (Approx.)
				Min	Max.			
11	E60B11H	3.000	B	1	$1\frac{1}{4}$	$1\frac{1}{16}$	3	2.5
12	E60B12H	3.250	B	1	$1\frac{1}{16}$	$2\frac{1}{8}$	3	3.3
13	E60B13H	3.490	B	1	$1\frac{1}{2}$	$2\frac{1}{4}$	3	3.9
14	E60B14H	3.740	B	1	$1\frac{3}{4}$	$2\frac{1}{2}$	3	4.5
15	E60B15H	3.980	B	1	$1\frac{7}{8}$	$2\frac{3}{16}$	3	5.4
16	E60B16H	4.220	B	1	2	3	3	6.5
17	E60B17H	4.460	B	1	$2\frac{1}{4}$	$3\frac{1}{4}$	3	7.7
18	E60B18H	4.700	B	1	$2\frac{3}{8}$	$3\frac{1}{2}$	3	8.5
19	E60B19H	4.950	B	1	$2\frac{1}{2}$	$3\frac{3}{16}$	3	10.0
20	E60B20H	5.190	B	1	$2\frac{1}{2}$	$3\frac{3}{4}$	3	11.2
21	E60B21H	5.430	B	1	$2\frac{3}{4}$	$4\frac{1}{8}$	3	12.5
22	E60B22H	5.670	B	1	$2\frac{3}{4}$	$4\frac{1}{4}$	3	13.2
23	E60B23H	5.910	B	1	$2\frac{3}{4}$	$4\frac{1}{4}$	3	14.6
24	E60B24H	6.150	B	1	$2\frac{3}{4}$	$4\frac{1}{4}$	3	15.8
25	E60B25H	6.390	B	1	$2\frac{3}{4}$	$4\frac{1}{4}$	3	17.0
26	E60B26	6.630	B	1	$2\frac{3}{4}$	$4\frac{1}{4}$	3	18.6
30	E60B30	7.590	B	1	$2\frac{3}{4}$	$4\frac{1}{4}$	3	23.2
35	E60B35	8.780	B	$1\frac{1}{4}$	3	$4\frac{1}{2}$	$3\frac{1}{4}$	34.5
36	E60B36	9.020	B	$1\frac{1}{4}$	3	$4\frac{1}{2}$	$3\frac{1}{4}$	37.0
42	E60B42	10.460	B	$1\frac{1}{4}$	$3\frac{1}{4}$	$4\frac{3}{4}$	$3\frac{5}{8}$	49.0
45	E60B45	11.180	B	$1\frac{1}{4}$	$3\frac{1}{4}$	$4\frac{3}{4}$	$3\frac{5}{8}$	57.0
52	E60C52	12.850	C	$1\frac{1}{4}$	$3\frac{1}{4}$	$4\frac{3}{4}$	$3\frac{1}{2}$	73.0
60	E60C60	14.760	C	$1\frac{1}{4}$	$3\frac{1}{4}$	$4\frac{3}{4}$	$3\frac{1}{2}$	63.0
68	E60C68	16.670	C	$1\frac{1}{4}$	$3\frac{1}{4}$	5	$3\frac{1}{2}$	73.0
72	E60C72	17.630	C	$1\frac{1}{4}$	$3\frac{1}{4}$	5	$3\frac{1}{2}$	85.0
76	E60C76	18.580	C	$1\frac{1}{2}$	$3\frac{1}{4}$	$5\frac{1}{2}$	$3\frac{1}{2}$	82.0
95	E60C95	23.120	C	$1\frac{1}{2}$	$3\frac{1}{4}$	$5\frac{1}{2}$	4	105.0

NOTE: Double 60 stock sprockets with 25 teeth or less have Hardened teeth.

Maximum bores shown will accommodate standard keyseat and setscrew over keyseat.

Slightly larger bores are possible with no keyseat, shallow keyseat, or setscrew at angle to keyseat.

Steel Stock Sprockets American Standard Series

No.80

◇ Pitch 1" ◇ Roller Φ 0.625" ◇ Tooth width B1 0.575"

Single-Type A

Single-Type B & C

No. Teeth	De	Type	Number	D1	Weight Lbs. (Approx.)	Number	Type	D1		Dm	A	Weight Lbs. (Approx.)
								Min	Max.			
8	3.010					80B08	B	1	1	1 ¹⁵ / ₁₆ *	1 ⁵ / ₈	1.4
9	3.350	A	80A09	¹⁵ / ₁₆	.8	80B09	B	1	1 ⁵ / ₁₆	2 ¹ / ₄ *	1 ⁵ / ₈	1.6
10	3.680	A	80A10	¹⁵ / ₁₆	1.0	80B10	B	1	1 ¹ / ₂	2 ⁹ / ₁₆ *	1 ⁵ / ₈	2.2
11	4.010	A	80A11	¹⁵ / ₁₆	1.3	80B11	B	1	1 ⁵ / ₈	2 ¹³ / ₁₆ *	1 ⁵ / ₈	3.2
12	4.330	A	80A12	¹⁵ / ₁₆	1.5	80B12	B	1	1 ⁷ / ₈	3 ¹ / ₈ *	1 ⁵ / ₈	3.4
13	4.660	A	80A13	¹⁵ / ₁₆	1.8	80B13	B	1	2	3	1 ¹ / ₂	3.5
14	4.980	A	80A14	¹⁵ / ₁₆	2.2	80B14	B	1	2 ¹ / ₄	3 ¹ / ₄	1 ¹ / ₂	4.1
15	5.300	A	80A15	¹⁵ / ₁₆	2.5	80B15	B	1	2 ¹ / ₂	3 ¹³ / ₁₆	1 ¹ / ₂	5.3
16	5.630	A	80A16	¹⁵ / ₁₆	2.9	80B16	B	1	2 ³ / ₄	4	1 ¹ / ₂	5.9
17	5.950	A	80A17	¹⁵ / ₁₆	3.3	80B17	B	1	2 ³ / ₄	4	1 ¹ / ₂	6.6
18	6.270	A	80A18	¹⁵ / ₁₆	3.7	80B18	B	1	2 ³ / ₄	4 ¹ / ₄	1 ¹ / ₂	7.3
19	6.590	A	80A19	¹⁵ / ₁₆	4.1	80B19	B	1	2 ³ / ₄	4 ¹ / ₄	1 ¹ / ₂	7.8
20	6.910	A	80A20	¹⁵ / ₁₆	4.7	80B20	B	1	2 ³ / ₄	4 ¹ / ₄	1 ¹ / ₂	8.4
21	7.240	A	80A21	¹⁵ / ₁₆	4.9	80B21	B	1	2 ³ / ₄	4 ¹ / ₄	1 ³ / ₄	9.4
22	7.560	A	80A22	¹⁵ / ₁₆	5.5	80B22	B	1	2 ³ / ₄	4 ¹ / ₄	1 ³ / ₄	10.0
23	7.880	A	80A23	¹⁵ / ₁₆	6.3	80B23	B	1	2 ³ / ₄	4 ¹ / ₄	1 ³ / ₄	10.7
24	8.200	A	80A24	¹⁵ / ₁₆	6.7	80B24	B	1	2 ³ / ₄	4 ¹ / ₄	1 ³ / ₄	11.3
25	8.520	A	80A25	¹⁵ / ₁₆	7.2	80B25	B	1	2 ³ / ₄	4 ¹ / ₄	1 ³ / ₄	11.9
26	8.840	A	80A26	1 ³ / ₁₆	7.8	80B26	B	1 ¹ / ₄	3 ¹ / ₄	4 ³ / ₄	2	14.3
27	9.160	A	80A27	1 ³ / ₁₆	8.6	80B27	B	1 ¹ / ₄	3 ¹ / ₄	4 ³ / ₄	2	15.4
28	9.480	A	80A28	1 ³ / ₁₆	9.3	80B28	B	1 ¹ / ₄	3 ¹ / ₄	4 ³ / ₄	2	16.0
29	9.800	A	80A29	1 ³ / ₁₆	9.8	80B29	B	1 ³ / ₁₆	3 ¹ / ₄	4 ³ / ₄	2	17.1
30	10.110	A	80A30	1 ³ / ₁₆	10.7	80B30	B	1 ³ / ₁₆	3 ¹ / ₄	4 ³ / ₄	2	17.4
31	10.430	A	80A31	1 ³ / ₁₆	11.3	80B31	B	1 ³ / ₁₆	3 ¹ / ₄	4 ³ / ₄	2	18.7
32	10.750	A	80A32	1 ³ / ₁₆	12.1	80B32	B	1 ³ / ₁₆	3 ¹ / ₄	4 ³ / ₄	2	19.5
33	11.070	A	80A33	1 ³ / ₁₆	13.6	80B33	B	1 ³ / ₁₆	3 ¹ / ₄	4 ³ / ₄	2	19.6
34	11.390	A	80A34	1 ³ / ₁₆	14.3	80B34	B	1 ³ / ₁₆	3 ¹ / ₄	4 ³ / ₄	2	21.3
35	11.710	A	80A35	1 ³ / ₁₆	14.8	80B35	B	1 ³ / ₁₆	3 ¹ / ₄	4 ³ / ₄	2	22.1
36	12.030	A	80A36	1 ³ / ₁₆	16.1	80B36	B	1 ³ / ₁₆	3 ¹ / ₄	4 ³ / ₄	2	23.1
37	12.350	A	80A37	1 ³ / ₁₆	16.8	80B37	B	1 ³ / ₁₆	3 ¹ / ₄	4 ³ / ₄	2	23.8
38	12.670	A	80A38	1 ³ / ₁₆	17.2	80B38	B	1 ³ / ₁₆	3 ¹ / ₄	4 ³ / ₄	2	24.7
39	12.990	A	80A39	1 ³ / ₁₆	17.9	80B39	B	1 ³ / ₁₆	3 ¹ / ₄	4 ³ / ₄	2	25.6
40	13.310	A	80A40	1 ³ / ₁₆	18.9	80B40	B	1 ³ / ₁₆	3 ¹ / ₄	4 ³ / ₄	2	26.7
41	13.630	A	80A41	1 ¹ / ₄	21.0	80B41	B	1 ¹ / ₄	3 ¹ / ₄	4 ³ / ₄	2	27.8
42	13.940	A	80A42	1 ¹ / ₄	21.8	80B42	B	1 ¹ / ₄	3 ¹ / ₄	4 ³ / ₄	2	28.7
43	14.260	A	80A43	1 ¹ / ₄	23.6	80B43	B	1 ¹ / ₄	3 ¹ / ₄	4 ³ / ₄	2	29.4
44	14.580	A	80A44	1 ¹ / ₄	24.3	80B44	B	1 ¹ / ₄	3 ¹ / ₄	4 ³ / ₄	2	29.9
45	14.900	A	80A45	1 ¹ / ₄	25.2	80B45	B	1 ¹ / ₄	3 ¹ / ₄	4 ³ / ₄	2	31.4
46	15.220	A	80A46	1 ¹ / ₄	26.6	80B46	B	1 ¹ / ₄	3 ¹ / ₄	4 ³ / ₄	2	33.1
47	15.540	A	80A47	1 ¹ / ₄	26.4	80B47	B	1 ¹ / ₄	3 ¹ / ₄	4 ³ / ₄	2	34.0
48	15.860	A	80A48	1 ¹ / ₄	27.8	80B48	B	1 ¹ / ₄	3 ¹ / ₄	4 ³ / ₄	2	35.5
49	16.180	A	80A49	1 ¹ / ₄	28.9	80B49	B	1 ¹ / ₄	3 ¹ / ₄	4 ³ / ₄	2	35.8
50	16.500	A	80A50	1 ¹ / ₄	30.9	80B50	B	1 ¹ / ₄	3 ¹ / ₄	4 ³ / ₄	2	37.3
51	16.810	A	80A51	1 ¹ / ₄	32.2	80B51	B	1 ¹ / ₄	3 ¹ / ₄	4 ³ / ₄	2	38.6
52	17.130	A	80A52	1 ¹ / ₄	33.0	80B52	B	1 ¹ / ₄	3 ¹ / ₄	4 ³ / ₄	2	39.4
53	17.450	A	80A53	1 ¹ / ₄	34.9	80B53	B	1 ¹ / ₄	3 ¹ / ₄	4 ³ / ₄	2	41.3
54	17.770	A	80A54	1 ¹ / ₄	36.6	80B54	B	1 ¹ / ₄	3 ¹ / ₂	5 ¹ / ₄	2	44.7
55	18.090	A	80A55	1 ¹ / ₄	37.5	80B55	B	1 ¹ / ₄	3 ¹ / ₂	5 ¹ / ₄	2	45.6
56	18.410	A	80A56	1 ¹ / ₄	39.4	80B56	B	1 ¹ / ₄	3 ¹ / ₂	5 ¹ / ₄	2	47.5
57	18.730	A	80A57	1 ¹ / ₄	40.4	80B57	B	1 ¹ / ₄	3 ¹ / ₂	5 ¹ / ₄	2	48.5
58	19.040	A	80A58	1 ¹ / ₄	41.3	80B58	B	1 ¹ / ₄	3 ¹ / ₂	5 ¹ / ₄	2	50.5
59	19.360	A	80A59	1 ¹ / ₄	42.9	80B59	B	1 ¹ / ₄	3 ¹ / ₂	5 ¹ / ₄	2	52.1
60	19.680	A	80A60	1 ¹ / ₄	45.3	80B60	B	1 ¹ / ₄	3 ¹ / ₂	5 ¹ / ₄	2	54.5
65	21.270	A	80A65	1 ¹ / ₄	52.2	80B65	B	1 ¹ / ₄	3 ¹ / ₂	5 ¹ / ₄	2	61.8
70	22.870	A	80A70	1 ¹ / ₂	59.8	80C70	C	1 ¹ / ₂	4 ¹ / ₄	6 ¹ / ₄	3 ¹ / ₂	75.7
72	23.500	A	80A72	1 ¹ / ₂	65.7	80C72	C	1 ¹ / ₂	4 ¹ / ₄	6 ¹ / ₄	3 ¹ / ₂	81.4
76	24.780	A	80A76	1 ¹ / ₂	70.2	80C76	C	1 ¹ / ₂	4 ¹ / ₄	6 ¹ / ₄	3 ¹ / ₂	87.8
80	26.050	A	80A80	1 ¹ / ₂	79.6	80C80	C	1 ¹ / ₂	4 ¹ / ₄	6 ¹ / ₄	3 ¹ / ₂	89.9
84	27.330	A	80A84	1 ¹ / ₂	86.1	80C84	C	1 ¹ / ₂	4 ¹ / ₄	6 ¹ / ₄	3 ¹ / ₂	99.2
90	29.240	A	80A90	1 ¹ / ₂	101	80C90	C	1 ¹ / ₂	4 ¹ / ₄	6 ¹ / ₄	3 ¹ / ₂	106
96	31.150	A	80A96	1 ¹ / ₂	120	80C96	C	1 ¹ / ₂	4 ¹ / ₄	6 ¹ / ₄	3 ¹ / ₂	117
112	36.240	A	80A112	1 ¹ / ₂	165	80C112	C	1 ¹ / ₂	4 ¹ / ₄	6 ¹ / ₄	3 ¹ / ₂	154

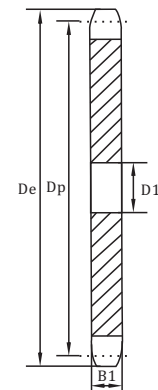

TYPE A

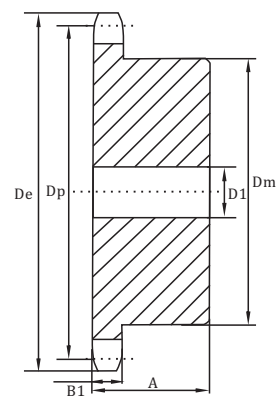
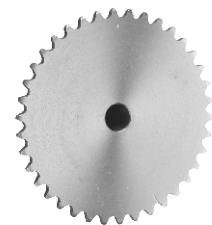

TYPE B

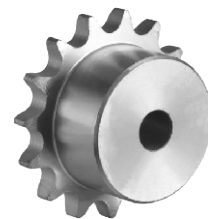

★ Has recessed groove in hub for chain clearance.
Maximum bores shown will accommodate standard keyseat and setscrew over keyseat.
Slightly larger bores are possible with no keyseat, shallow keyseat, or setscrew at angle to keyseat.

Steel Stock Sprockets American Standard Series

No.80-2

◇ Pitch 1" ◇ Roller Φ 0.625" ◇ Tooth width b1 0.557" ◇ Tooth width B2 1.710"

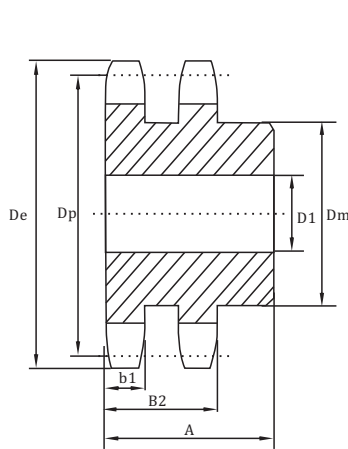

TYPE B

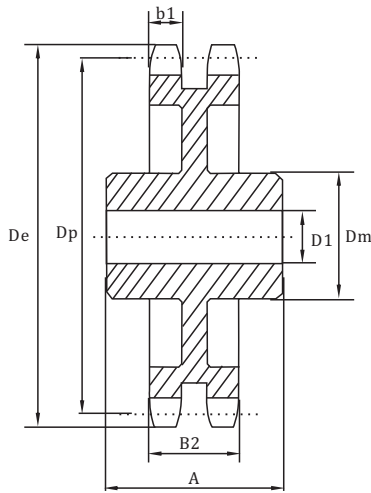

TYPE C



Double-Type B & C

No. Teeth	Number	De	Type	D1		Dm	A	Weight Lbs. (Approx.)
				Min	Max.			
10	D80B10H	3.680	B	1	1 1/2	2 9/16 *	2 3/4	3.6
11	D80B11H	4.010	B	1	1 3/4	2 1/2	2 1/2	4.0
12	D80B12H	4.330	B	1	1 7/8	2 27/32	2 1/2	5.1
13	D80B13H	4.660	B	1	2 1/4	3 5/32	2 1/2	6.3
14	D80B14H	4.980	B	1	2 3/8	3 15/32	2 1/2	7.6
15	D80B15H	5.300	B	1	2 1/2	3 51/64	2 1/2	9.0
16	D80B16H	5.630	B	1	2 3/4	4	2 3/4	11.0
17	D80B17H	5.950	B	1	3	4 27/64	2 3/4	13.2
18	D80B18H	6.270	B	1	3 1/4	4 47/64	2 3/4	15.0
19	D80B19H	6.590	B	1	3 7/16	5	2 3/4	17.0
20	D80B20H	6.910	B	1	3 7/16	5	2 3/4	18.2
21	D80B21H	7.240	B	1	3 7/16	5	2 3/4	19.6
22	D80B22H	7.560	B	1	3 7/16	5	2 3/4	21.0
23	D80B23H	7.880	B	1	3 7/16	5	2 3/4	22.8
24	D80B24H	8.200	B	1	3 1/2	5 1/4	2 3/4	25.1
25	D80B25H	8.520	B	1	3 1/2	5 1/4	3	28.3
26	D80B26	8.840	B	1	3 1/2	5 1/4	3	29.9
30	D80B30	10.110	B	/	3 3/4	5 3/4	3	39.5
32	D80B32	10.750	B	/	3 3/4	5 3/4	3	43.8
35	D80B35	11.710	B	/	3 3/4	5 3/4	3	49.1
36	D80B36	12.030	B	/	3 3/4	5 3/4	3 1/8	54.2
42	D80B42	13.940	B	/	3 3/4	5 3/4	3 1/8	71.5
45	D80B45	14.900	B	/	3 3/4	5 3/4	3 1/8	73.5
52	D80C52	17.130	C	/	3 3/4	5 3/4	3 3/4	78.4
60	D80C60	19.680	C	/	3 3/4	5 3/4	3 3/4	93.4
68	D80C68	22.230	C	/	3 13/16	6	4	96.2
76	D80C76	24.780	C	/	3 13/16	6	4	113
95	D80C95	30.830	C	/	4	6	4 1/4	165

★ Has recessed groove in hub for chain clearance.

NOTE: Triple 80 stock sprockets with 25 teeth or less have Hardened teeth.

Maximum bores shown will accommodate standard keyseat and setscrew over keyseat.

Slightly larger bores are possible with no keyseat, shallow keyseat, or setscrew at angle to keyseat.

Steel Stock Sprockets American Standard Series

No.80-3

◇ Pitch 1" ◇ Roller Φ 0.625"
 ◇ Tooth width b1 0.557" ◇ Tooth width B2 1.710" ◇ Tooth width B3 2.863"

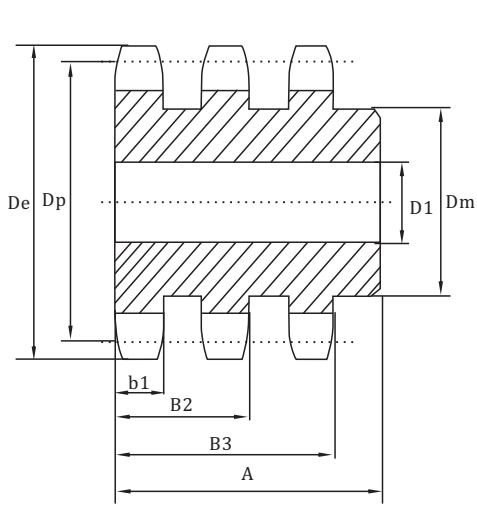

TYPE B

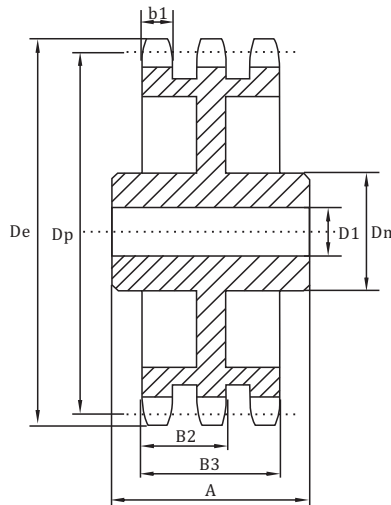

TYPE C

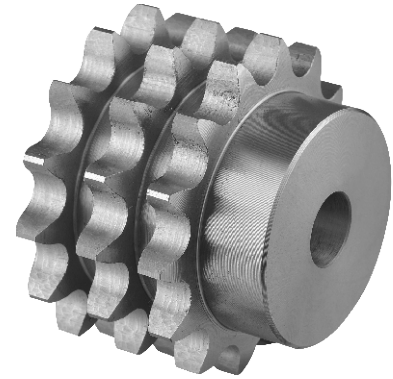

Triple-Type B & C

No. Teeth	Number	De	Type	D1		Dm	A	Weight Lbs. (Approx.)
				Min	Max.			
11	E80B11H	4.010	B	1	1 3/4	2 1/2	3 7/8	5.9
12	E80B12H	4.330	B	1	1 7/8	2 7/32	3 7/8	7.5
13	E80B13H	4.660	B	1	2 1/4	3 5/32	3 7/8	9.2
14	E80B14H	4.980	B	1	2 3/8	3 15/32	3 7/8	11.0
15	E80B15H	5.300	B	1	2 1/2	3 5/64	3 7/8	13.1
16	E80B16H	5.630	B	1	2 3/4	4	3 7/8	15.8
17	E80B17H	5.950	B	1	3	4 27/64	3 7/8	18.6
18	E80B18H	6.270	B	1	3 1/4	4 47/64	3 7/8	21.2
19	E80B19H	6.590	B	1	3 5/16	5	3 7/8	23.7
20	E80B20H	6.910	B	1	3 5/16	5	3 7/8	26.0
21	E80B21H	7.240	B	1	3 5/16	5	3 7/8	28.4
22	E80B22H	7.560	B	1	3 5/16	5	3 7/8	31.0
23	E80B23H	7.880	B	1	3 5/16	5	3 7/8	33.6
24	E80B24H	8.200	B	1	3 1/2	5 1/4	3 7/8	37.1
25	E80B25H	8.520	B	1	3 1/2	5 1/4	3 7/8	40.1
26	E80B26	8.840	B	1	3 1/2	5 1/4	3 7/8	42.9
30	E80B30	10.110	B	1 1/4	3 3/4	5 3/4	4 1/4	54.5
35	E80B35	11.710	B	1 1/4	3 3/4	5 3/4	4 1/4	79.5
36	E80B36	12.030	B	1 1/4	3 3/4	5 3/4	4 1/4	83.9
42	E80C42	13.940	C	1 1/4	3 13/16	6	4 1/2	84.9
45	E80C45	14.900	C	1 1/4	3 13/16	6	4 1/2	92.4
52	E80C52	17.130	C	1 1/2	3 13/16	6	4 1/2	107
60	E80C60	19.680	C	1 1/2	4 1/4	6 1/4	4 3/4	128
68	E80C68	22.230	C	1 1/2	4 1/4	6 1/4	4 3/4	140
76	E80C76	24.780	C	1 1/2	4 1/4	6 1/4	4 3/4	165
95	E80C95	30.830	C	1 1/2	4 1/2	6 3/4	5	240

NOTE: Triple 80 stock sprockets with 25 teeth or less have Hardened teeth.

Maximum bores shown will accommodate standard keyseat and setscrew over keyseat.

Slightly larger bores are possible with no keyseat, shallow keyseat, or setscrew at angle to keyseat.

Steel Stock Sprockets American Standard Series

No.100

◇ Pitch 1-1/4"

◇ Roller Φ 0.750"

◇ Tooth width B1 0.692"

Single-Type A

Single-Type B & C

No. Teeth	De	Type	Number	D1	Weight Lbs. (Approx.)	Number	Type	D1		Dm	A	Weight Lbs. (Approx.)
								Min	Max.			
7	3.350		100A07	1	1.2							
8	3.770		100A08	1	1.4	100B08	B	1	1 1/4	2 7/16*	1 7/8	2.3
9	4.180		100A09	1	1.6	100B09	B	1	1 5/8	2 13/16*	1 7/8	3.2
10	4.600		100A10	1	2.0	100B10	B	1	1 7/8	3 1/4 *	1 7/8	4.1
11	5.010	A	100A11	1 1/4	2.5	100B11	B	1	2 1/4	3 9/16*	1 7/8	5.3
12	5.420	A	100A12	1 1/4	3.0	100B12	B	1	2 1/4	4 *	1 7/8	6.4
13	5.820	A	100A13	1 1/4	3.5	100B13	B	1	2 3/8	3 7/8	1 7/8	6.6
14	6.230	A	100A14	1 1/4	4.1	100B14	B	1 1/4	2 3/4	4 3/16	1 7/8	7.4
15	6.630	A	100A15	1 1/4	4.7	100B15	B	1 1/4	3	4 1/2	1 3/4	9.2
16	7.030	A	100A16	1 1/4	5.4	100B16	B	1 5/16	3	4 1/2	1 3/4	9.9
17	7.440	A	100A17	1 1/4	6.1	100B17	B	1 5/16	3	4 1/2	1 3/4	10.8
18	7.840	A	100A18	1 1/4	7.0	100B18	B	1 5/16	3	4 1/2	1 3/4	11.5
19	8.240	A	100A19	1 1/4	7.8	100B19	B	1 5/16	3	4 1/2	2	13.1
20	8.640	A	100A20	1 1/4	8.8	100B20	B	1 5/16	3	4 1/2	2	14.2
21	9.040	A	100A21	1 1/4	9.8	100B21	B	1 5/16	3	4 1/2	2	15.3
22	9.440	A	100A22	1 1/4	10.5	100B22	B	1 5/16	3	4 1/2	2	16.1
23	9.840	A	100A23	1 1/4	11.8	100B23	B	1 1/4	3	4 1/2	2	17.2
24	10.250	A	100A24	1 1/4	12.8	100B24	B	1 1/4	3	4 1/2	2	19.2
25	10.650	A	100A25	1 1/4	13.9	100B25	B	1 1/4	3	4 1/2	2	19.5
26	11.050	A	100A26	1 1/4	15.0	100B26	B	1 1/4	3 5/16	5	2	21.7
27	11.440	A	100A27	1 1/4	16.0	100B27	B	1 1/4	3 5/16	5	2	23.0
28	11.840	A	100A28	1 1/4	17.4	100B28	B	1 1/4	3 5/16	5	2	24.4
29	12.240	A	100A29	1 1/4	19.6	100B29	B	1 1/4	3 5/16	5	2	25.0
30	12.640	A	100A30	1 1/4	20.1	100B30	B	1 1/4	3 5/16	5	2	26.9
31	13.040	A	100A31	1 1/4	21.5							
32	13.440	A	100A32	1 1/4	22.6	100B32	B	1 1/4	3 5/16	5	2	29.8
33	13.840	A	100A33	1 1/4	24.1							
34	14.240	A	100A34	1 1/4	26.0							
35	14.640	A	100A35	1 1/4	27.2	100B35	B	1 1/4	3 5/16	5	2 1/2	36.9
36	15.040	A	100A36	1 1/4	30.0	100B36	B	1 1/4	3 5/16	5	2 1/2	38.6
37	15.440	A	100A37	1 1/4	31.0							
38	15.840	A	100A38	1 1/4	33.0	100B38	B	1 1/4	3 5/16	5	2 1/2	41.5
39	16.230	A	100A39	1 1/4	35.0	100B39	B	1 1/4	3 5/16	5	2 1/2	43.6
40	16.630	A	100A40	1 1/4	36.0	100B40	B	1 1/4	3 5/16	5	2 1/2	46.9
41	17.030	A	100A41	1 1/4	39.0							
42	17.430	A	100A42	1 1/4	40.0	100B42	B	1 1/4	3 5/16	5	2 1/2	50.4
43	17.830	A	100A43	1 1/2	43.0							
44	18.230	A	100A44	1 1/2	45.0							
45	18.630	A	100A45	1 1/2	47.0	100B45	B	1 1/2	3 5/16	5	2 1/2	54.0
46	19.020	A	100A46	1 1/2	48.0							
47	19.420	A	100A47	1 1/2	52.0							
48	19.820	A	100A48	1 1/2	54.0	100B48	B	1 1/2	4	6	2 1/2	66.0
49	20.220	A	100A49	1 1/2	56.0							
50	20.620	A	100A50	1 1/2	57.0							
51	21.020	A	100A51	1 1/2	63.0							
52	21.420	A	100A52	1 1/2	64.0							
53	21.810	A	100A53	1 1/2	64.2							
54	22.210	A	100A54	1 1/2	68.0	100C54	C	1 1/2	4	6	3 1/4	78.0
55	22.610	A	100A55	1 1/2	70.0							
56	23.010	A	100A56	1 1/2	72.0							
57	23.410	A	100A57	1 1/2	75.8							
58	23.810	A	100A58	1 1/2	76.0							
59	24.200	A	100A59	1 1/2	77.0							
60	24.600	A	100A60	1 1/2	80.0	100C60	C	1 1/2	4	6	3 1/4	89.0
70	28.580	A	100A70	1 1/2	113	100C70	C	1 1/2	5 1/4	7	3 3/4	125
72	29.380	A	100A72	1 1/2	119	100C72	C	1 1/2	5 1/4	7	3 3/4	134
76	30.973	A	100A76	1 1/2	133	100C76	C	1 1/2	5 1/4	7	3 3/4	143
80	32.570	A	100A80	1 1/2	146	100C80	C	1 1/2	5 1/4	7	3 3/4	151
84	34.160	A	100A84	1 1/2	162	100C84	C	1 1/2	5 1/4	7	3 3/4	170
90	36.550	A	100A90	1 1/2	193	100C90	C	1 1/2	5 1/4	7	3 3/4	184
96	38.930	A	100A96	1 1/2	215	100C96	C	1 1/2	5 1/4	7	4 1/2	203

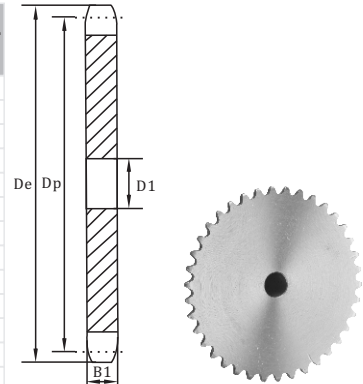

TYPE A

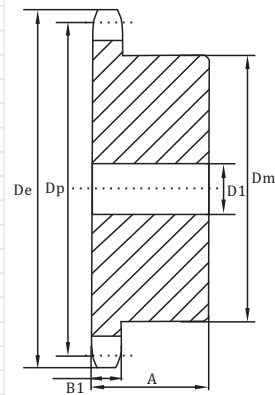

TYPE B

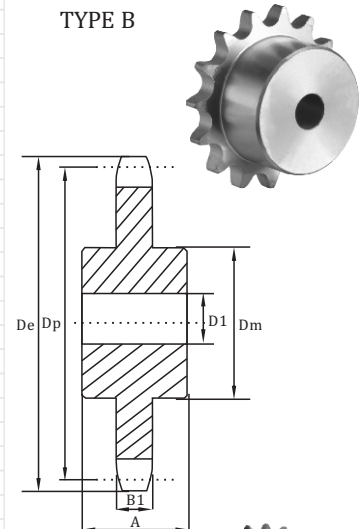

TYPE C

★ Has recessed groove in hub for chain clearance.

Maximum bores shown will accommodate standard keyseat and setscrew over keyseat.

Slightly larger bores are possible with no keyseat, shallow keyseat, or setscrew at angle to keyseat.

Steel Stock Sprockets American Standard Series

No.100-2

◇ Pitch 1-1/4" ◇ Roller Φ 0.750" ◇ Tooth width b1 0.669" ◇ Tooth width B2 2.077"

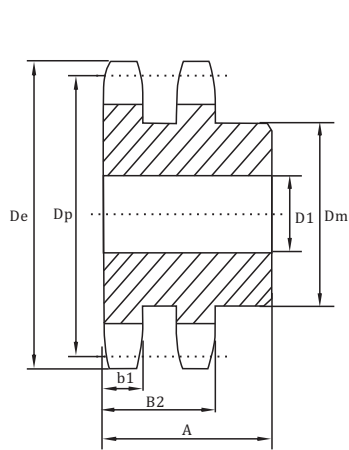

TYPE B

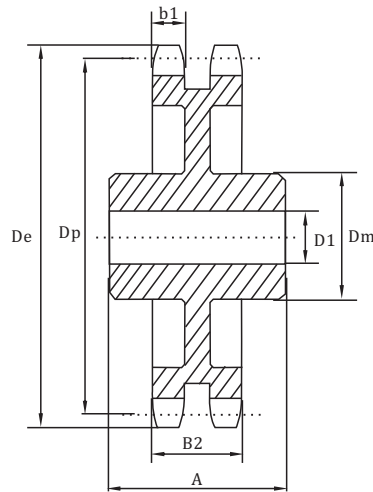

TYPE C



Double-Type B & C

No. Teeth	Number	De	Type	D1		Dm	A	Weight Lbs. (Approx.)
				Min	Max.			
9	D100B09	4.180	B	1	1 5/8	2 3/8	2 7/8	4.6
10	D100B10	4.600	B	1	1 7/8	2 3/4	2 7/8	6.2
11	D100B11	5.010	B	1	2 1/8	3 1/8	2 7/8	7.9
12	D100B12	5.420	B	1 1/8	2 1/4	3 3/8	2 7/8	9.3
13	D100B13	5.820	B	1 1/8	2 1/2	3 13/16	2 7/8	11.4
14	D100B14	6.230	B	1 1/8	2 3/4	4 3/16	2 7/8	13.6
15	D100B15	6.630	B	1 1/4	3 1/8	4 5/8	3 3/8	17.1
16	D100B16	7.030	B	1 1/4	3 5/16	5	3 3/8	20.1
17	D100B17	7.440	B	1 1/4	3 1/2	5 1/4	3 3/8	23.1
18	D100B18	7.840	B	1 1/4	3 1/2	5 1/4	3 3/8	25.4
19	D100B19	8.240	B	1 1/4	3 3/4	5 1/2	3 3/8	29.6
20	D100B20	8.640	B	1 1/4	3 3/4	5 1/2	3 3/8	32.4
21	D100B21	9.040	B	1 1/4	3 3/4	5 1/2	3 3/8	35.3
22	D100B22	9.440	B	1 1/4	3 3/4	5 1/2	3 3/8	38.4
23	D100B23	9.840	B	1 1/4	3 3/4	5 1/2	3 3/8	41.3
24	D100B24	10.250	B	1 1/4	3 3/4	5 3/4	3 3/8	45.1
25	D100B25	10.650	B	1 1/4	3 3/4	5 3/4	3 3/8	48.5
26	D100B26	11.050	B	1 1/2	3 3/4	5 3/4	3 3/8	51.5
30	D100B30	12.640	B	1 1/2	3 3/4	5 3/4	3 3/8	65.0
35	D100C35	14.640	C	1 1/2	3 13/16	6	4 1/4	75.0
45	D100C45	18.630	C	1 1/2	3 13/16	6	4 1/2	103
60	D100C60	24.600	C	1 1/2	5 3/8	7 1/2	5	175
70	D100C70	28.580	C	1 1/2	5 3/8	7 1/2	5	197
80	D100C80	32.570	C	1 1/2	5 3/8	7 1/2	5	231

Maximum bores shown will accommodate standard keyseat and setscrew over keyseat.
Slightly larger bores are possible with no keyseat, shallow keyseat, or setscrew at angle to keyseat.

Steel Stock Sprockets American Standard Series

No.100-3

◇ Pitch 1-1/4" ◇ Roller Φ 0.750"
 ◇ Tooth width b1 0.669" ◇ Tooth width B2 2.077" ◇ Tooth width B3 3.485"

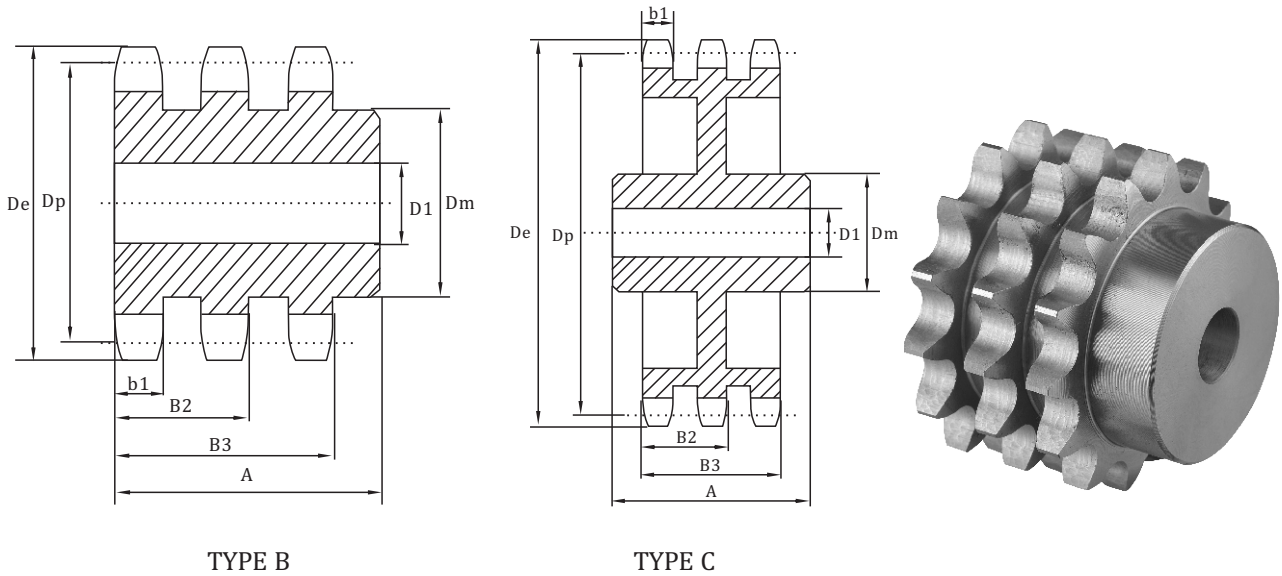

Triple-Type B & C

No. Teeth	Number	De	Type	D1		Dm	A	Weight Lbs. (Approx.)
				Min	Max.			
11	E100B11	5.010	B	1	2 1/8	3 1/8	4 1/4	11.7
12	E100B12	5.420	B	1 1/8	2 1/4	3 3/8	4 1/4	13.7
13	E100B13	5.820	B	1 1/8	2 1/2	3 13/16	4 1/4	16.9
14	E100B14	6.230	B	1 1/8	2 3/4	4 3/16	4 1/4	20.2
15	E100B15	6.630	B	1 1/4	3 1/8	4 5/8	4 1/2	25.0
16	E100B16	7.030	B	1 1/4	3 1/16	5	4 1/2	29.3
17	E100B17	7.440	B	1 1/4	3 1/2	5 1/4	4 1/2	33.8
18	E100B18	7.840	B	1 1/4	3 1/2	5 1/4	4 3/4	38.6
19	E100B19	8.240	B	1 1/4	3 3/4	5 1/2	4 3/4	43.3
20	E100B20	8.640	B	1 1/4	3 3/4	5 1/2	4 3/4	47.9
21	E100B21	9.040	B	1 1/4	3 3/4	5 1/2	4 3/4	52.3
22	E100B22	9.440	B	1 1/4	3 3/4	5 1/2	4 3/4	57.5
23	E100B23	9.840	B	1 1/4	3 3/4	5 1/2	4 3/4	62.5
24	E100B24	10.250	B	1 1/4	3 3/4	5 3/4	4 3/4	69
25	E100B25	10.650	B	1 1/4	3 3/4	5 3/4	4 3/4	73
26	E100B26	11.050	B	1 1/2	3 13/16	5 3/4	4 3/4	79
30	E100B30	12.640	B	1 1/2	3 13/16	5 3/4	4 3/4	103
35	E100C35	14.640	C	1 1/2	4	6	5	108
45	E100C45	18.630	C	1 1/2	4	6	5	143
60	E100C60	24.600	C	1 1/2	5 3/8	7 1/2	5	217
70	E100C70	25.580	C	1 1/2	5 3/8	7 1/2	5	262
80	E100C80	32.570	C	1 1/2	5 3/8	7 1/2	5	313

Maximum bores shown will accommodate standard keyseat and setscrew over keyseat.
 Slightly larger bores are possible with no keyseat, shallow keyseat, or setscrew at angle to keyseat.

Steel Stock Sprockets American Standard Series

No.120

◇Pitch 1-1/2" ◇Roller Φ 0.875" ◇Tooth width B1 0.924"

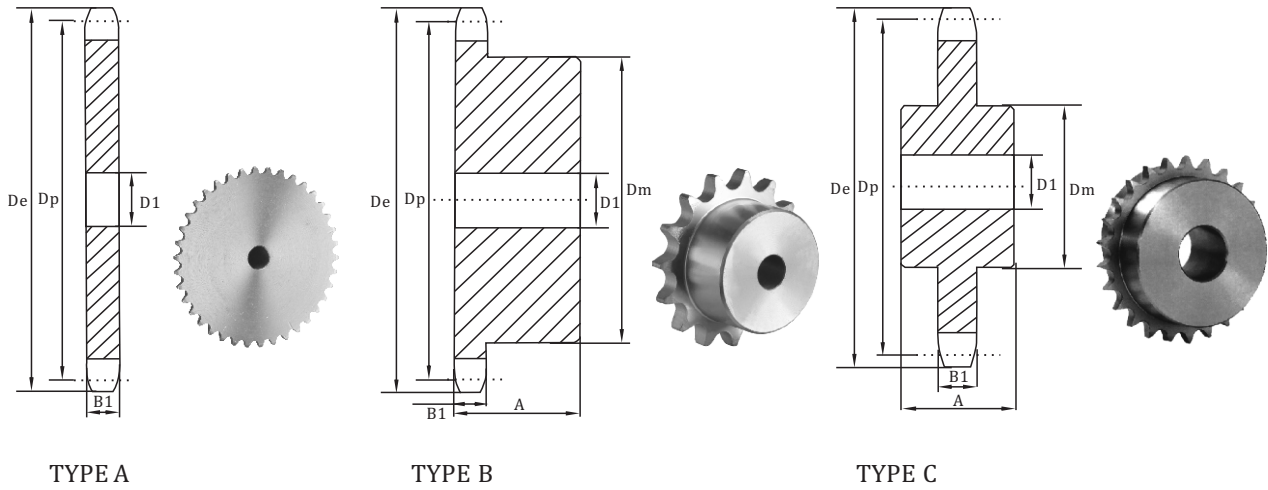

Single-Type A

Single-Type B

No. Teeth	De	Type	Number	D1	Weight Lbs. (Approx.)	Number	Type	D1		Dm	A	Weight Lbs. (Approx.)
								Min	Max.			
8	4.520		120A08	1 1/4	2.4							
9	5.020	A	120A09	1 1/4	3.0	120B09	B	3/8	1 3/16	3 3/8 *	2 1/4	5.3
10	5.520	A	120A10	1 1/4	3.8	120B10	B	3/8	2 1/4	3 3/4 *	2 1/4	7.1
11	6.010	A	120A11	1 1/4	4.8	120B11	B	3/8	2 3/8	3 9/16	2 1/8	7.6
12	6.500	A	120A12	1 1/4	5.8	120B12	B	3/8	2 3/4	4 1/8	2 1/8	9.9
13	6.990	A	120A13	1 1/4	6.7	120B13	B	3/8	3	4 7/16	2 1/4	12.4
14	7.470	A	120A14	1 1/4	8.0	120B14	B	3/8	3 1/4	4 3/4	2 1/4	14.4
15	7.960	A	120A15	1 1/4	9.1	120B15	B	1 1/4	3 1/4	4 3/4	2 3/8	16.7
16	8.440	A	120A16	1 1/4	10.6	120B16	B	1 1/4	3 1/2	5 1/4	2 3/8	19.9
17	8.920	A	120A17	1 1/4	12.6	120B17	B	1 1/4	3 1/2	5 1/4	2 3/8	20.8
18	9.410	A	120A18	1 1/4	13.6	120B18	B	1 1/4	3 1/2	5 1/4	2 3/8	22.2
19	9.890	A	120A19	1 1/4	15.1	120B19	B	1 1/4	3 1/2	5 1/4	2 3/8	24.8
20	10.370	A	120A20	1 1/4	16.9	120B20	B	1 1/4	3 1/2	5 1/4	2 3/8	25.8
21	10.850	A	120A21	1 1/4	18.7	120B21	B	1 1/4	3 1/2	5 1/4	2 3/8	26.7
22	11.330	A	120A22	1 1/4	20.0	120B22	B	1 1/4	3 1/2	5 1/4	2 3/8	28.2
23	11.810	A	120A23	1 1/4	22.1	120B23	B	1 1/4	3 1/2	5 1/4	2 3/8	30.3
24	12.290	A	120A24	1 1/4	24.8	120B24	B	1 1/4	3 1/2	5 1/4	2 3/8	32.1
25	12.770	A	120A25	1 1/4	26.8	120B25	B	1 1/4	3 1/2	5 1/4	2 3/8	34.6
26	13.250	A	120A26	1 1/4	28.3	120B26	B	1 1/2	4	6	2 1/2	40.0
27	13.730	A	120A27	1 1/2	30.9							
28	14.210	A	120A28	1 1/2	33.6	120B28	B	1 1/2	4	6	2 1/2	44.9
30	15.170	A	120A30	1 1/2	39.0	120B30	B	1 1/2	4	6	2 1/2	50.2
32	16.130	A	120A32	1 1/2	43.9	120B32	B	1 1/2	4	6	2 1/2	56.0
33	16.610	A	120A33	1 1/2	48.2							
34	17.090	A	120A34	1 1/2	50							
35	17.570	A	120A35	1 1/2	52	120B35	B	1 1/2	4	6	2 1/2	62.4
36	18.050	A	120A36	1 1/2	56	120B36	B	1 1/2	4	6	2 1/2	66.4
40	19.960	A	120A40	1 1/2	71	120C40	C	1 1/2	4	6	3 3/4	92.0
42	20.920	A	120A42	1 1/2	75	120C42	C	1 1/2	4	6	3 3/4	98.0
45	22.350	A	120A45	1 1/2	88	120C45	C	1 1/2	4	6	3 3/4	99.2
48	23.790	A	120A48	1 1/2	103	120C48	C	1 1/2	4	6	4	113
54	26.650	A	120A54	1 1/2	140	120C54	C	1 1/2	4	6	4	133
60	29.520	A	120A60	1 1/2	160	120C60	C	1 1/2	5 1/4	7	4	160
70	34.300	A	120A70	1 1/2	216	120C70	C	1 1/2	5 3/8	7 1/2	4 1/2	206
80	39.080	A	120A80	1 1/2	284	120C80	C	1 1/2	5 3/8	7 1/2	4 1/2	254
90	43.850	A	120A90	1 1/2	358							

★ Has recessed groove in hub for chain clearance.

Steel Stock Sprockets American Standard Series

No.120-2

◇ Pitch 1-1/2" ◇ Roller Φ 0.875" ◇ Tooth width b1 0.894" ◇ Tooth width B2 2.683"

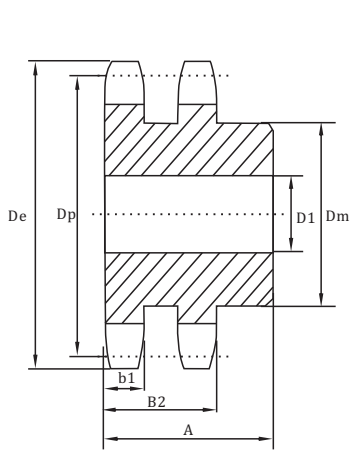

TYPE B

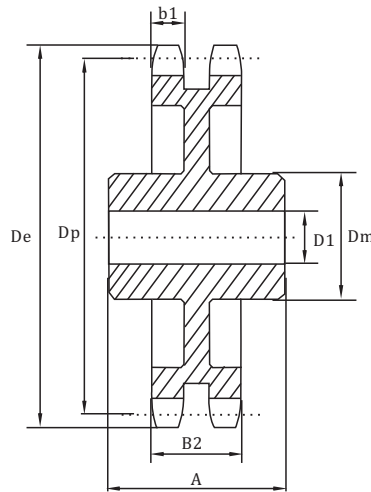

TYPE C



Double-Type B & C

No. Teeth	Number	De	Type	D1		Dm	A	Weight Lbs. (Approx.)
				Min	Max.			
11	D120B11	6.010	B	1 ..	2 7/8	3 9/16	3 3/4	13.6
12	D120B12	6.500	B	1 1/2	2 3/4	4 1/16	3 3/4	17.3
13	D120B13	6.990	B	1 1/2	3	4 1/2	3 3/4	21.1
14	D120B14	7.470	B	1 1/2	3 5/16	5	3 3/4	25.6
15	D120B15	7.960	B	1 1/2	3 1/2	5 1/4	3 3/4	29.9
16	D120B16	8.440	B	1 1/2	3 1/2	5 1/4	3 3/4	33.8
17	D120B17	8.920	B	1 1/2	3 1/2	5 1/4	3 3/4	36.9
18	D120B18	9.410	B	1 1/2	3 1/2	5 1/4	3 3/4	41.9
19	D120B19	9.890	B	1 1/2	3 1/2	5 1/4	3 3/4	46.5
20	D120B20	10.370	B	1 1/2	3 1/2	5 1/2	3 3/4	50.2
21	D120B21	10.850	B	1 1/2	3 1/2	5 1/2	3 3/4	55.6
22	D120B22	11.330	B	1 1/2	3 13/16	5 3/4	4	64.0
23	D120B23	11.810	B	1 1/2	4 1/2	6 1/2	4	75.0
24	D120B24	12.290	B	1 1/2	4 1/2	6 1/2	4	79.0
25	D120B25	12.770	B	1 1/2	4 1/2	6 1/2	4	84.0
26	D120B26	13.250	B	1 1/2	4 1/2	6 1/2	4	90.0
30	D120B30	15.170	B	1 1/2	4 1/2	6 1/2	4	119
35	D120C35	17.570	C	1 1/2	5 3/8	7 1/2	6	148
45	D120C45	22.350	C	1 1/2	5 3/8	7 1/2	6	188
60	D120C60	29.520	C	1 1/2	6 3/8	9 1/2	6 1/4	307

Maximum bores shown will accommodate standard keyseat and setscrew over keyseat.
Slightly larger bores are possible with no keyseat, shallow keyseat, or setscrew at angle to keyseat.